

KEYWORD SEARCH >

## Techniques: Using Ice Resin with Paper

Beading Techniques > New Techniques > Using Ice Resin with Paper

### CRYSTALLIZED™ - Swarovski Elements

Crystal Beads  
Crystal Pendants  
Crystal Components  
Crystal Pearls  
Crystal Sew-On Stones

### GLASS BEADS

Glass Beads  
Lampwork Glass Beads  
Cubic Zirconia Beads  
Artist Beads

### JAPANESE SEED BEADS

Round Seed Beads  
Seed Bead Shapes  
Delicas by Number  
Delicas by Color

### NATURAL BEADS

Gemstone Beads  
Freshwater Pearls  
Wood, Shell, Horn, Bone  
Felt and Resin Beads

### METAL BEADS

Alphabet Beads  
Silver Beads  
Gold Beads  
Brass Beads  
Copper Beads  
Thai Hill Tribe Silver

### CHARMS AND PENDANTS

Silver Charms  
Gold Charms  
Brass Charms  
Copper Charms  
Stamping Blanks & Charms  
Collage Pendants  
Pendants  
Buttons

### SILVER COMPONENTS

Findings  
Clasps  
Ear Wires  
Links, Caps, Components



#### Materials

- Scrapbook Paper
- ICE Resin
- White Glue
- White Plastic Garbage Bag (to cover work area)

#### Tools

- Sponge or Paint Brush
- Paper Punch and/or Scissors
- Small Hole Punch (optional)

**Tip:** Try using different materials such as photos, stamps or playing cards.



**Step 1**  
We have taped a white garbage bag down over our work surface to prevent spills and drips as well as resin from sticking to the work surface. Using a white craft glue, coat the back of the paper you are going to use.



**Step 2**  
Using a small sponge spread the glue evenly.



**Step 3**  
Fold the paper in half. Press the paper flat and smooth out any air bubbles.

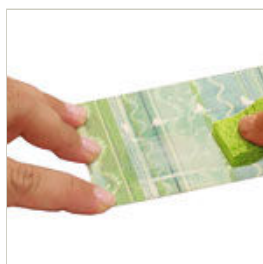

**Step 4**  
Using the small sponge coat the front of the paper with the white craft glue. The glue will



**Step 5**  
Once the glue has dried completely use a paper punch and find the desired image



**Step 6**  
You have now punched out a circle with the paper punch.

Bangles and Rings  
Artist Findings

**GOLD COMPONENTS**

Findings  
Clasps  
Ear Wires  
Links, Caps, Components  
Bangles and Rings

**BRASS COMPONENTS**

Findings, Clasps, Earwires  
Links and Components

**COPPER COMPONENTS**

Findings  
Clasps  
Ear Wires  
Links, Caps, Components

**BASE METAL COMPONENTS**

Findings  
Clasps  
Ear Wires  
Bead Craft Findings  
Filigree and Components

**STRINGING MATERIALS**

Chain  
Wire  
Beading Wire  
Beading Thread  
Elastic and Cord  
Wire Lace Ribbon

**TOOLS AND SUPPLIES**

Bead Kits  
Add a Bead Products  
Beading Tools  
Design Tools  
Storage Supplies  
Gift Bags and Boxes  
Books

**NEW AND SPECIALS**

New Products  
Specials  
Gift Certificate

**FREE SHIPPING!**  
FusionBeads.com offers free standard shipping on all domestic orders. No minimum purchase required.

seal the paper or image keeping the Ice Resin from seeping into the paper. Let dry. Repeat for the other side.



**Step 7**  
Always measure the resin and hardener in equal amounts. With a permanent marker mark your measuring cup so the measurements you are using are easier to see. We have made our first mark at 1/4 fl. oz.

you want to use on the paper. Punch out the paper. We used a 13/16" circle paper punch.



**Step 8**  
With a permanent marker make your second mark. The two measurements should now be of equal amounts. We have made our second mark at 1/2 fl. oz.



**Step 9**  
Make sure the cup is resting on an even surface and pour the resin (part A) into the measuring cup filling it until the first marked line. We are filling it until the 1/4 fl. oz. marked line. At first the resin (part A) has a slight blue tint to it.



**Step 10**  
Pour the hardener (part B) into the measuring cup filling it until the second marked line. We are filling it until the 1/2 fl. oz. marked line. At first the hardener (part B) has a slight yellow tint to it.



**Step 11**  
Using a stir stick mix the resin and hardener together by folding very gently to avoid any bubbles.



**Step 12**  
Continue mixing, making sure you scrape the sides of the measuring cup so the resin and hardener get completely mixed together. Mix for a minimum of two minutes. Once the resin is done it should look clear.



**Step 13**  
Using a small sponge coat the paper with Ice Resin on both sides. Let dry. The Ice Resin will not stick to the white garbage bag.

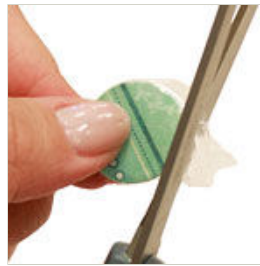

**Step 14**  
Using scissors cut any Ice Resin that may be around the edges of the paper.



**Step 15**  
You have now completely covered your paper with Ice Resin. This will make the paper water resistant which will allow you to use it in several different ways within your jewelry designs.



**Step 16**

To make a charm out of the resined paper punch a hole near the top of your paper. We have used metal hole punch pliers.



**Step 17**

Congratulations! You have created a unique Ice Resin charm to use in your jewelry designs.

[View Cart](#)

[Email This Page](#)

[Bookmark This Page](#)

[Return To Top](#)

---

ORDER QUESTIONS [orders@fusionbeads.com](mailto:orders@fusionbeads.com) PRODUCT QUESTIONS & REQUESTS [info@fusionbeads.com](mailto:info@fusionbeads.com) CUSTOMER SERVICE 1.888.781.3559

---

[Contact Us](#) | [Customer Service](#) | [Frequently Asked Questions](#) | [Return Policy](#)

---

[Privacy Policy](#) | [Terms of Use](#) | [Safe Shopping Guarantee](#) | [Site Map](#) | © 2009 Fusion Beads Inc.