

Beachside by FusionBeads.com



Approximate finished length: 7.5 inches

Beads and other products needed for one bracelet:

- 4 - Pacific Opal Swarovski Crystal Bicone Beads - 5328 - 6mm - Pacific Opal (06BI1120)
- 3 - Light Turquoise Swarovski Crystal Bicone Beads - 5328 - 6mm (06BI1421)
- 2 - Indicolite Swarovski Crystal Bicone Beads - 5328 - 6mm (06BI1171)
- 1 - Pewter Faceted Drop Bead by Nunn Design - Antique Gold - 8mm (BM3545)
- 1 - Pewter Small Starfish Charm by Nunn Design - Antique Silver - 20mm (PE3480)
- 1 - Pewter Trumpet Shell Charm by Nunn Design - Antique Silver - 21mm (PE9176)
- 1 - Pewter Seahorse Charm by Nunn Design - Antique Gold - 23mm (PE3387)
- 1 - Pewter Coral Charm by Nunn Design - Antique Gold - 27mm (PE3345)
- 1 - Brass Rectangle Open Frame by Nunn Design - Antique Silver - 24mm (BM5213)
- 1 - Pewter Circle Bezel Pendant with Flat Loop by Nunn Design - Antique Silver - 26mm (BM5248)
- 1 - Pewter Small Circle Bezel Link by Nunn Design - Antique Silver - 29mm (PE8981)
- 1 - Pewter Rope Textured Charm Bracelet with Toggle Clasp by Nunn Design - 8 Inch - Antique Silver (BM0570)
- 9 - Brass Textured Open Jump Rings by Nunn Design - Antique Silver - 16 gauge - 6mm (BM3326)
- 9 - Base Metal Head Pins - Silver - 22 gauge - 2 inch (BM2703)
- 1 - Crystal Clay - White - 25 grams (CR0850)
- 1 - Opaque Liquid Pigment – Yellow (CR0266)
- 1 - Opaque Liquid Pigment – Blue (CR0268)
- 1 - Pearl Ex Powdered Pigment - Brilliant Gold (CR0298)

Tools needed to complete the bracelet:

- 1/2 lb. Silicone Mold Putty (CR0275)
- Resin Kit by Nunn Design (TL3151)
- 5 Piece Nylon Paint Brush Set (CR0659)
- Round nose pliers
- Chain nose pliers
- Wire cutters
- Toothpicks

Beading Techniques needed to complete the bracelet:

- Making a Silicone Mold
- Using ICE Resin with Bezel Pendants
- Adding Color to ICE Resin

Opening and Closing a Jump Ring Simple Loop



Instructions to complete “Beachside” bracelet:

Step 1

Pinch off a ball about 1 inch in diameter of putty component A, and roll it in your hands (See Making a Silicone Mold Technique). Repeat with the same size of component B. Knead the two balls together until the putty is a solid color and no longer marbled. The silicone putty has a working time of three minutes before it begins to set, so this process should take no longer than one minute.



Step 2

Roll the putty mixture into a ball. Evenly flatten the ball on a smooth, flat work surface. Make sure the putty’s surface is smooth.



Step 3

Press the trumpet shell charm into the putty to form the mold. Make sure the charm is pressed evenly into the putty. Leave the charm in the putty for at least 25 minutes to set.

**Step 4**

Repeat Steps 1 – 3 with the starfish charm.

Step 5

Wearing gloves, pinch off equal amounts of Crystal Clay jewelry clay components A and B (see Jewelry Clay Bead Technique). Knead the two balls of clay together with your fingers for four minutes until the clay is a solid color and no longer marbled.

**Step 6**

Use the palms of your hands to roll the clay into a smooth, round ball. The ball should fit into the circle bezel pendant. Press the ball into the bezel link with a slight dome on top.



Step 7

Place the trumpet shell mold face up on the work surface. Place the clay-filled bezel over the mold. Press the bezel and the mold gently together, creating an impression.

**Step 8**

Remove the bezel and clay from the mold. Clean away any excess clay from around the bezel's edge.

**Step 9**

Repeat Steps 5 – 8 with the small circle bezel link and the same trumpet shell mold.

Step 10

Mixing a smaller amount of clay, repeat Steps 5 – 8. The amount of clay should fit into the rectangle open frame.

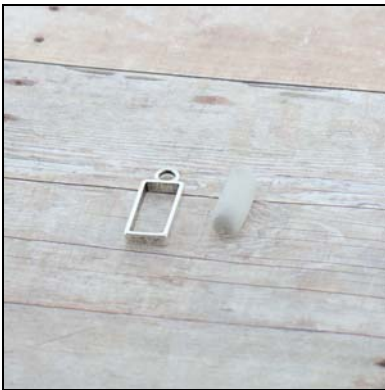

Step 11

Place the starfish mold face up on the work surface. Place the clay-filled rectangle open frame over only half the starfish mold. In the same manner as in Step 7, press the frame and the mold gently together, creating an impression.



Step 12

Repeat Step 8.



Step 13

Dust gold Pearl Ex powdered pigment onto the clay exposed on both sides of the frame, and brush off excess.



Step 14

Measure equal amounts of the resin and hardener (see Using ICE Resin with Bezel Pendants Technique). Using a stir stick, mix the resin and hardener together by folding very gently to prevent bubbles. Continue mixing, scraping the sides of the measuring cup so the resin and hardener are completely combined. Continue mixing for at least two minutes. The resin will look transparent and colorless when done.



Step 15

Using a toothpick, apply a few drops of yellow and blue opaque liquid pigment to the resin (see Adding Color to ICE Resin Technique). Using a clean stir stick, mix the color into the resin.

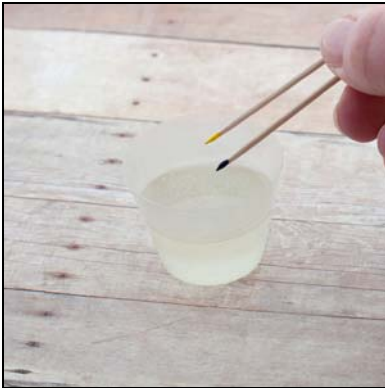

Step 16

Using a toothpick, carefully pick up small amounts of colored resin, and apply it to the top of the crystal clay in the bezel link a little at a time. Using a clean toothpick, clean off excess resin carefully so that it doesn't flow over the edge of the bezel. Keep checking the resin as it settles, and continue cleaning off excess as needed.



Step 17

Repeat Step 16 with the small circle bezel link. Allow the resin in both the pendant and the link to set for 12 to 24 hours.

Step 18

Lay the charm bracelet horizontally on the work surface with the ring side of the toggle clasp on the left, and the bar side on the right. Leave the first chain link attached to the toggle ring. The links of the chain are unsoldered and can be opened and closed like jump rings (see Opening and Closing a Jump Ring Technique). Open the second and sixth chain links and remove those five links from the bracelet. (The bezel link will fill in the space left from the removed chain links in the next steps.)

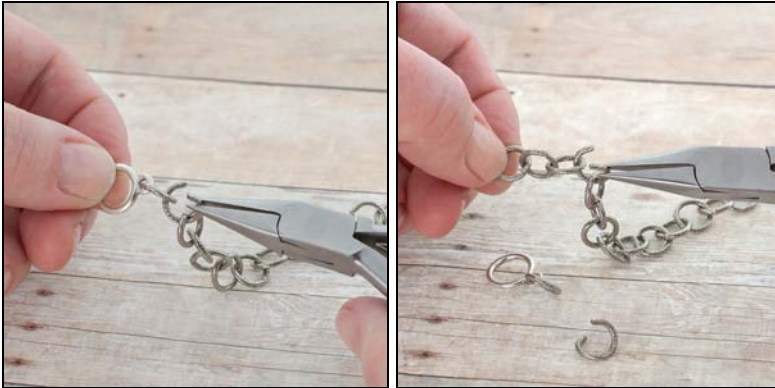

Step 19

Open one jump ring. Use the jump ring to attach one side of the bezel link to the single chain link still attached to the toggle ring. Close the jump ring.



Step 20

Use one jump ring to attach the second side of the bezel link to the first chain link on the longer section of the bracelet.



Tip

In the remaining steps, beads and charms will be attached to the bracelet with jump rings and simple loops on head pins. Lay the charm bracelet horizontally on the work surface with the ring side of the toggle clasp on the left, and the bar side on the right. The chain link attached to the toggle ring will be link 1. The first chain link after the bezel link (attached in Step 20) will be link 2, followed by links 3, 4, 5 and so on across the chain.

Step 21

Place one 6mm Pacific Opal crystal bicone bead onto one head pin, making one unit (see Simple Loop Technique). Cut the head pin, leaving 3/8 inch of wire. Bend the wire at the top of the bead to a right angle with chain nose pliers or your fingers. Grasp the end of the wire with round nose pliers so the wire is flush with the tool. Rotate the pliers to form a loop. Continue turning the wire until a complete loop is formed.

**Step 22**

Repeat Step 21 for the remaining bicones.

**Step 23**

Attach the loop just made to the top of link 1.



Step 24

Open one jump ring, and use it to attach the seahorse charm to the bottom of link 2. Close the jump ring.



Step 35

In the same manner as in the previous steps, use simple loops or jump rings to attach these items to the specified chain links:

Link 3, top: 1 – 6mm Pacific Opal bicone bead

Link 5, top: 1 – 6mm Indicolite bicone bead

Link 5, bottom: starfish rectangle open frame

Link 7, bottom: trumpet shell charm

Link 8, top: 1 – 6mm Light Turquoise bicone bead

Link 10, top: 1 – 6mm Pacific Opal bicone bead

Link 10, bottom: coral charm

Link 12, top: 1 – 6mm Indicolite bicone bead

Link 14, top: 1 – 6mm Pacific Opal bicone bead

Link 14, bottom: trumpet shell circle bezel pendant

Link 16, top: 1 – 6mm Light Turquoise bicone bead

Link 17, bottom: starfish charm

Link 19, top: 1 – 6mm Pacific Opal bicone bead

Link 20, top: 1 – 8mm antique gold faceted drop bead



For step-by-step photos and instructions on these and other techniques, visit FusionBeads.com and select Beading Techniques from the top navigation bar. You'll find more Inspiration jewelry ideas at FusionBeads.com!